

**ITEM 23. ROAD WORKS – TEMPORARY ROAD CLOSURE AND TWO WAY
TRAFFIC – DALLEY STREET SYDNEY**

TRIM RECORD NO: 2015/589233

RECOMMENDATION

It is recommended that the Committee endorse the temporary road closure and two-way traffic in Dalley Street, Sydney, between George Street and Pitt Street, from 2 January to 16 February 2016, subject to the following conditions:

- (A) The Applicant must comply with the temporary road closure conditions as mentioned in Schedule C of this agenda;
- (B) The Applicant must comply with any other conditions imposed by City's Construction Regulation Unit;
- (C) The Applicant must contact the Sydney City Police to discuss deployment of user pay police for the road closure;
- (D) The Applicant is to obtain a Road Occupancy Licence from the Transport Management Centre prior to commencement of works;
- (E) The Applicant must consult with builder at 4 Dalley Street on the Works Zone operation to resolve any issue access for construction; and
- (F) The Applicant must provide a telephone number of the supervisor responsible for the proposed closure and include contact details in the notification letters to be distributed to affected stakeholders.

DECISION

BACKGROUND

The CBD and South East Light Rail (CBDSELR) project is to be delivered by the ALTRAC Light Rail Partnership. The CBDSELR will run from Circular Quay to Central Station via George Street, and on to Kingsford and Randwick via Surry Hills and Moore Park. The CBDSELR include stops, terminus, interchanges and other facilities for the maintenance and stabling light rail vehicles.

ALTRAC has applied for the temporary road closure of Dalley Street between George Street and Pitt Street from 2 January 2016 to 16 February 2016.

COMMENTS

The proposed temporary road is required to enable construction work at the Dalley Street and George Street intersection for service investigation and adjustments.

To establishment a safe work site, the traffic management arrangements are as follows:

- Close Dalley Street at George Street;

- Dalley Street be converted from one-way eastbound traffic to two-way traffic flow between Pitt Street and the driveway;
- Temporary kerb installation at the western end of Dalley Street at George Street with delineation;
- Installation of signage on George Street to support the closure of Dalley Street;
- Installation of signage and line marking modifications along Dalley Street to support the change from one-way to two-way;
- Install signage on Pitt Street to re-inforce one-way southbound traffic flow on Pitt Street; and
- Relocate blue parking station signage on Dalley Street at George Street to Dalley Street at Pitt Street.

The two-way traffic flow is provided between Pitt Street and driveways to 220 George Street Wilson parking station and 2 Bridge Street, with a temporary kerb arrangement in place to prevent access to George Street from Dalley Street.

It is proposed the Dalley Street works are undertaken during the utilities shutdown of George Street scheduled from 2nd to 11th January 2016.

Dalley Street will revert back to the one way movement upon completion works are 16 January 2016.

Currently, the number of vehicle turning from George Street to Dalley Street is approximately 60 vehicles per hour during the morning peak and significantly less in the evening peak.

There will be no impact on pedestrian access but cyclists will not be able to access Dalley Street from George Street due to the closure. Cyclists will be required to use Underwood Street or Pitt Street to access Dalley Street.

It is not anticipated there will be any conflict with traffic flow on Underwood Street due to the closure of Dalley Street at George Street.

Access to the western end of Dalley Street will require the removal of the Works Zone at 4 Dalley Street to allow for two way traffic west of Underwood Street.

The Applicant has provided a site-specific Traffic Control Plan that includes details of barricades, signs, flagmen and other traffic devices to implement the proposed road closure.

For the same period, George Street will be closed from Essex Street to King Street with cross streets access maintained (e.g. King Street, Bridge Street/Grosvenor Street etc).

The proposal has been reviewed by Transport for NSW's Taskforce and RMS which have accepted the arrangement.

CONSULTATION

The Applicant will be required to notify affected stakeholders as stipulated in Schedule C.

FINANCIAL

All costs associated with the proposed will be borne by the Applicant.

ATTACHMENTS

Road Works – Temporary Road Closure and Two Way Traffic – Dalley Street Sydney

Stephen Sherwin, Project Manager, Roads and Maritime Services

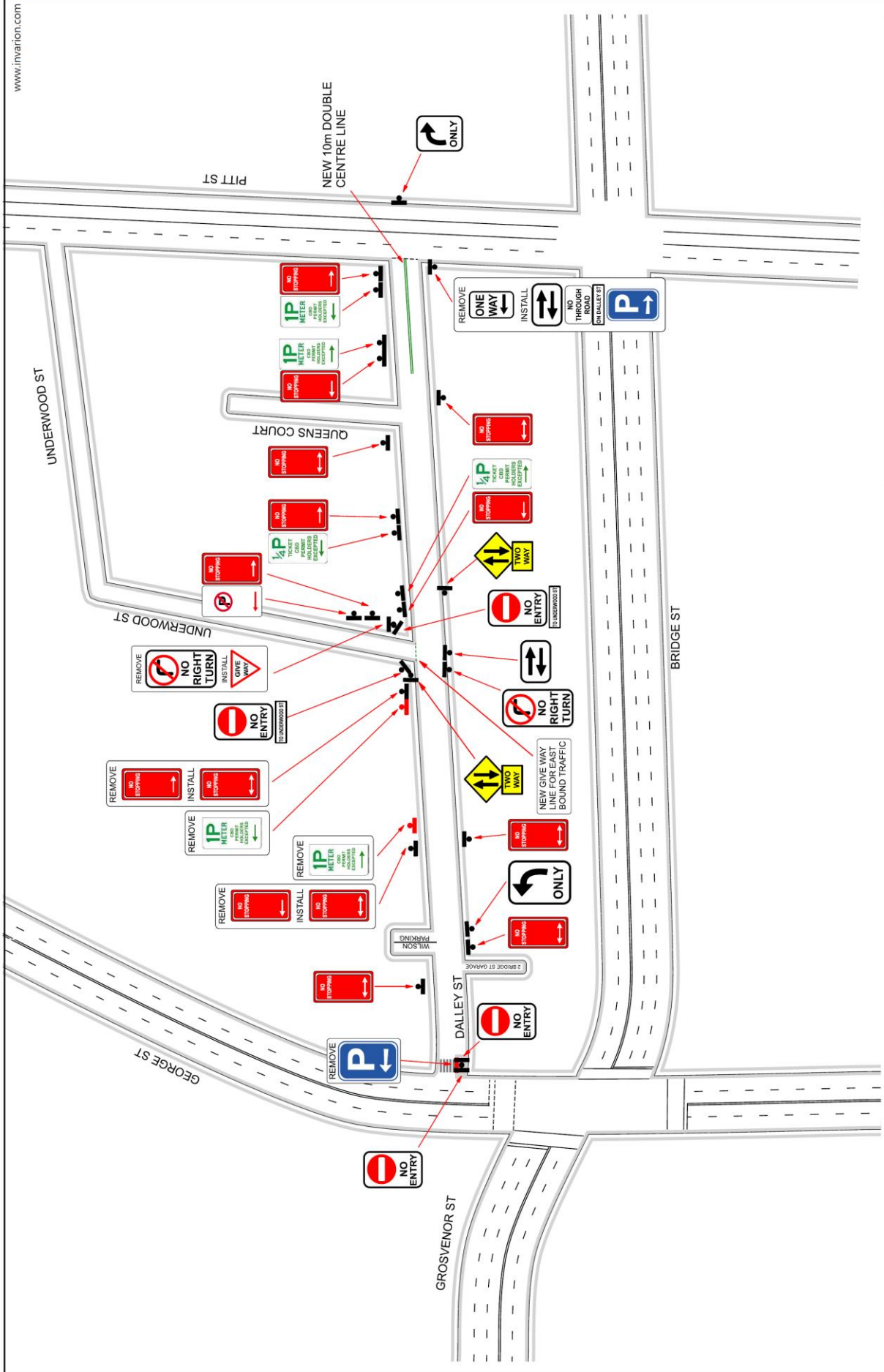

INSTALL TEMPORARY KERB ON DALLEY STREET AT GEORGE STREET IN LINE WITH EXISTING PERMANENT KERB AND EAST OF PEDESTRIAN CROSSING AT GEORGE ST

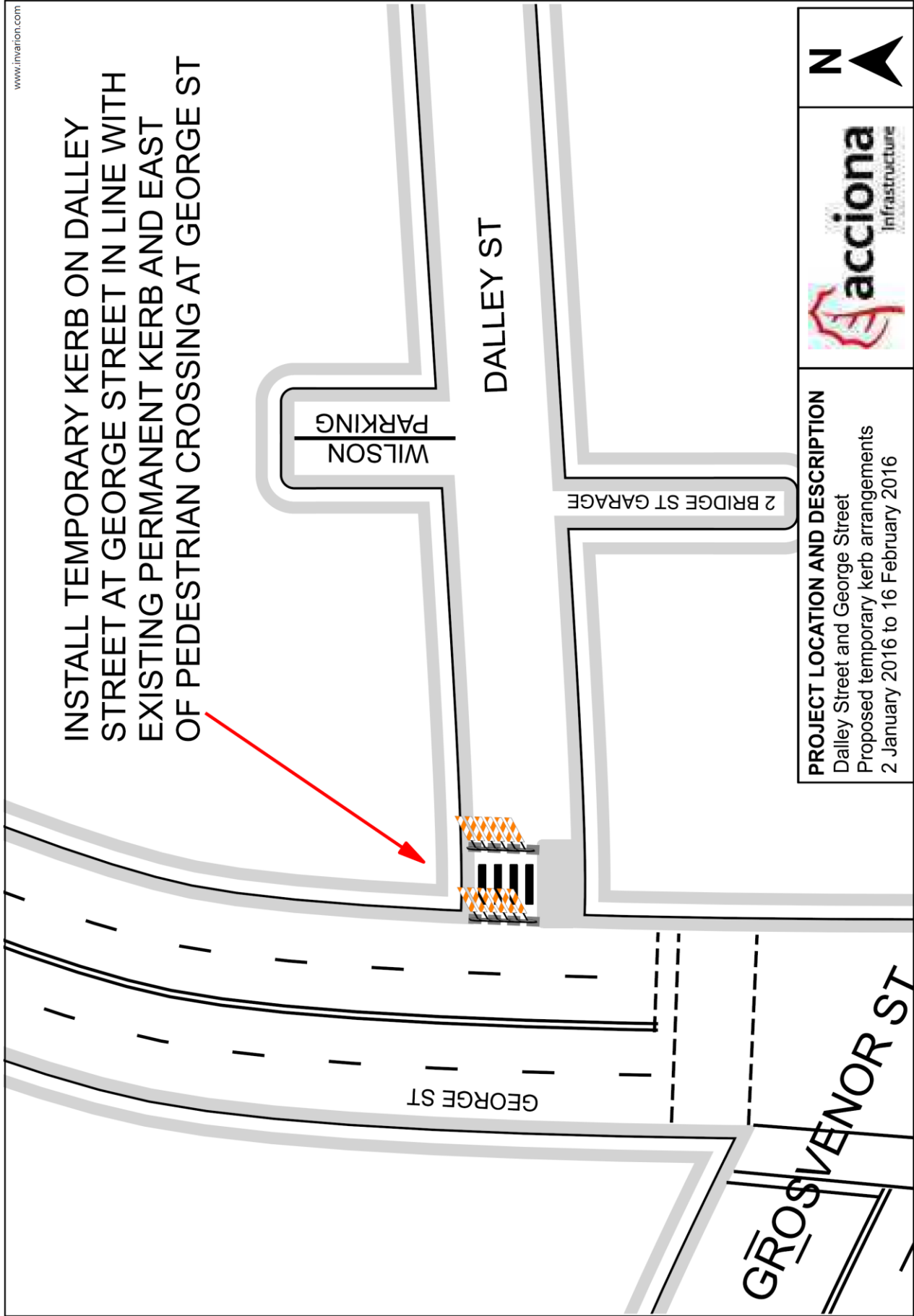

PROJECT LOCATION AND DESCRIPTION
Dalley Street and George Street
Proposed temporary kerb arrangements
2 January 2016 to 16 February 2016

